

# SUCTION STRAINER - S C 3

- REUSABLE SS 100 MESH / 149 MICRON STD.
- ALUMINIUM DIE CAST NUT
- STEEL CAP / SUPPORT TUBE
- CONTINUOUS EPOXY BOND
- MAX. WORKING TEMP. 80° C.
- SUITABLE FOR HYDRAULIC / MINERAL OIL

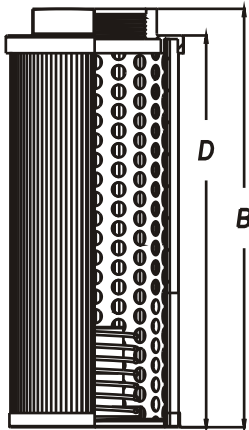
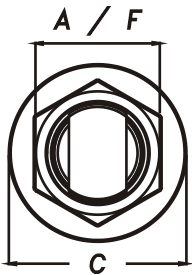
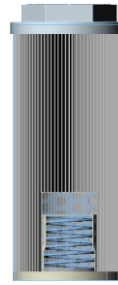

MODEL NO	FLOW LPM	THREAD SIZE A	CODE	OVERALL LENGTH B	LENGTH D	DIA NUT C	NUT A/F	SCREEN AREA (SQ. CMS)	WT KGS
SC3 - 002	8	1/4	02	90	77	46	24	187	0.10
SC3 - 003	12	3/8	03	90	77	46	24	187	0.10
SC3 - 005	20	1/2	04	105	92	46	30	226	0.10
SC3 - 007	28	3/4	06	109	94	64	35	406	0.20
SC3 - 010	40	1	08	139	124	64	46	542	0.20
SC3 - 015	60	1 - 1/4	10	139	125	86	51	929	0.30
SC3 - 020	80	1 - 1/2	12	168	154	86	60	1161	0.35
SC3 - 030	120	1 - 1/2	12	200	186	86	60	1393	0.40
SC3 - 040	160	2	16	235	220	100	70	1806	0.55
SC3 - 050	200	2	16	260	245	100	70	2032	0.60
SC3 - 075	300	2 - 1/2	20	211	186	150	90	2787	0.85
SC3 - 100	400	3	24	272	247	150	100	3677	1.00
SC3 - 150	600	3	24	345	320	150	100	4838	1.25

## MODEL CODE : ASSEMBLY

SC3	-015	-**	-**	-**	-**	-**
SERIES	SIZE	PORT THDS. CODE SIZE	PORT THDS. CONNECTION	MICRONS. OPTIONAL #	FEATURE. SPECIAL 1	FEATURE. SPECIAL 2
		REFER TABLE OMIT IF STD	<b>B-BSPP</b> - STD <b>N-NPT</b> - OPTIONAL	149-SS 100MESH- STD 125/100/ 74 / 63 - Microns OPTIONAL	<b>RB 3</b> - 3 PSI BYPASS Optional	

OMIT IF STANDARAD

CONSULT FACTORY, FOR OPTIONAL / SPECIAL FEATURE

DIMENSIONS IN MM FOR REFERENCE ONLY